

- 1
- 2
- 3
- 4
- 5
- 6
- 7
- 8
- 9
- 10
- 11
- 12
- 13
- 14
- 15
- 16
- 17
- 18

MATERIAL

Aluminium profile.

STANDARD EXECUTIONS

Threaded blind holes.

- **GN 730-EL**: anodised aluminium, natural colour, matte finish.
- **GN 730-SW**: epoxy resin coating, RAL 9005 black colour, matte finish.

APPLICATIONS

GN 730 handles are particularly suitable to fit machine guards.

SPECIAL EXECUTIONS ON REQUEST

- Natural aluminium (GN 730-BL).
- Different lengths.

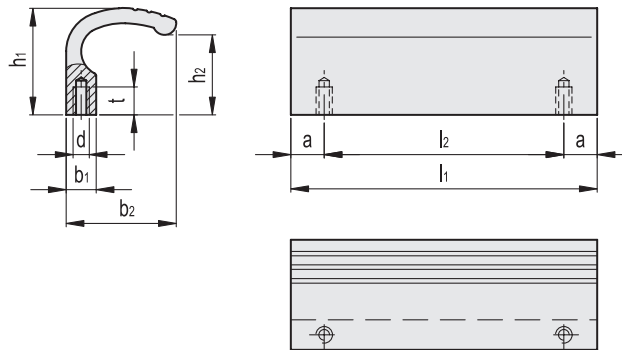

Conversion Table	
1 mm = 0.039 inch	
l1	
mm	inch
110	4.33
125	4.92
140	5.51

Code	Description	l1	l2	d	b1	b2	a	h1	h2	tmin	
GN.27721	GN 730-110-EL	110±0.25	90±0.25	M6	9.5	33	10	32	24	9	98
GN.27722	GN 730-110-SW	110±0.25	90±0.25	M6	9.5	33	10	32	24	9	100
GN.27726	GN 730-125-EL	125±0.25	105±0.25	M6	9.5	33	10	32	24	9	108
GN.27727	GN 730-125-SW	125±0.25	105±0.25	M6	9.5	33	10	32	24	9	110
GN.27731	GN 730-140-EL	140±0.25	120±0.25	M6	9.5	33	10	32	24	9	120
GN.27732	GN 730-140-SW	140±0.25	120±0.25	M6	9.5	33	10	32	24	9	125